

GENERAL INFORMATION

Project Name: _____
Item: _____
Quantity: _____
Model: CUSTOM CASH CART
Length: _____

STANDARD FEATURES

- 16 gauge #304 stainless steel countertop
- 18 gauge #304 stainless steel trim
- 6" casters, two (2) rigid and two (2) swivel with brakes
- Black rubber caster skirt on three (3) sides
- Stainless steel exterior panels
- Locking storage compartment
- Stainless steel shroud
- U.L. Listed
- NSF Listed to Standard 59

OPTIONS

- Custom panels (powder coated metal, laminate, stainless steel, etc.)
- Custom tops (corian, granite, etc.)
- Black vinyl bumper
- Custom graphics
- Cart cover

EQUIPMENT SUPPLIED BY OTHERS

- P.O.S. Station

ELECTRICAL REQUIREMENTS

- 120 Volt / 1 Phase / 20 Amp

CUSTOM CASH CART
3' Cart

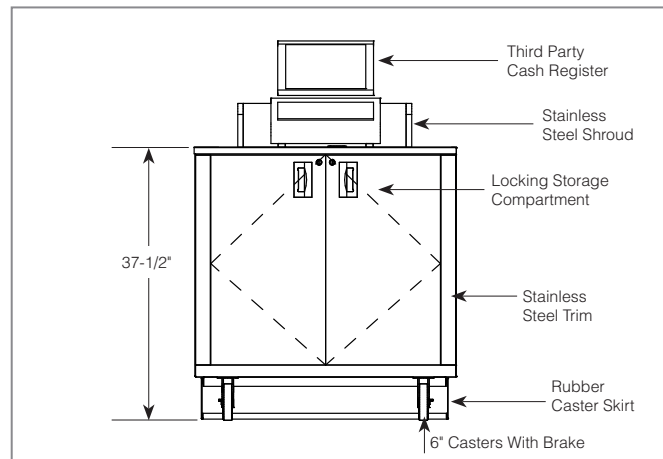
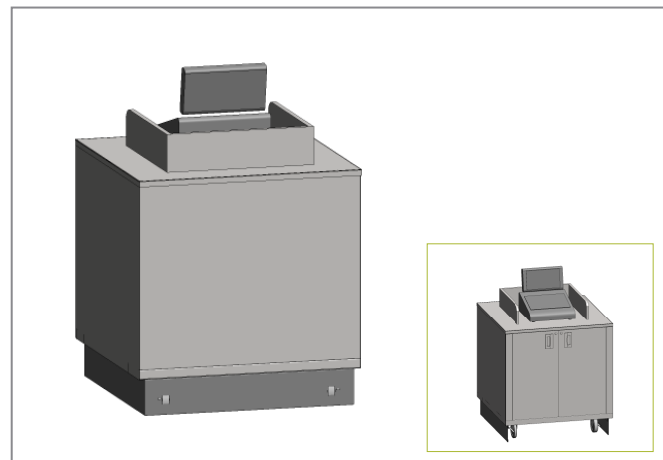

All fixtures and equipment to be connected to a single load center. Cart to have one (1) 8' power cable with a NEMA 5-20P plug.